

TECMEN TM1000

The Ultimate Welding Helmet for Maximum Visibility & Versatility

Best-in-class wide lens vision with a flip-front design – perfect for welders moving between welding and grinding jobs. The TM1000 connects easily to the FreFlow blower unit, keeping a cool, filtered airflow throughout the longest shifts.

Why Choose the TM1000?

The TM1000 maximizes workshop efficiency and safety by combining a flip-up auto-darkening welding lens, a clear 160-degree grinding visor, and PAPR respiratory protection into a single, versatile helmet. This eliminates the need for multiple pieces of equipment, allowing seamless transitions between welding, grinding, and general workshop tasks without removing your helmet. Wide-lens clarity, uninterrupted airflow, and an ergonomic design make it the go-to choice for welders looking for all-day protection and productivity.



Options:



**TM1000
with FreFlow**
Code: WSHWR95002



**TM1000
for FreFlow**
Code: WSHWR95001



**TM1000
Helmet Only**
Code: WSHWR95000



**TM1000 Hard Hat
for FreFlow**
Code: WSHWR95055

TM1000

Greater vision with Flip-Up Lens

Opening up a whole new vision to the welder's world!

Smooth flip-up function

Spring loaded for easy flip-up function and parked position.

Pivot headgear

Well balanced, and adjustable for max-comfort.

Side windows

Shade 5 lens on both sides, enhances surround vision for greater safety.

Superior lens technology

107 x 75mm Best optical class 1/1/1/1 Lens to bring true colour and clear vision to the welder.

Large grinding view

200x120mm curved and clear anti-fog lens.

High impact resistance

Australian and New Zealand standard AS/NZS 1337.1 compliant.

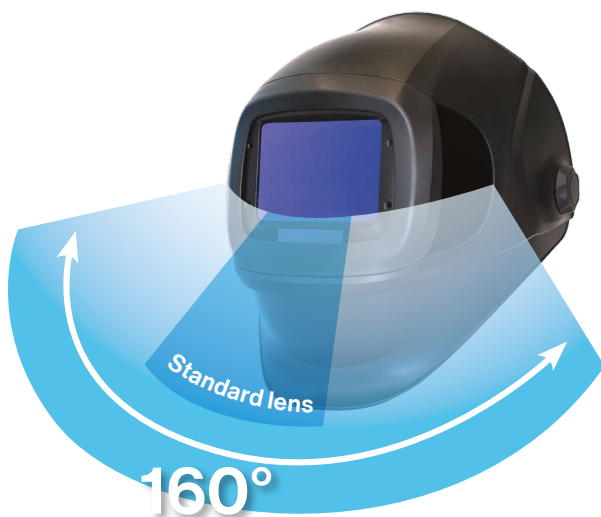

160° horizontal field of vision

Increased both safety and efficiency in your workplace, with a better field of vision.

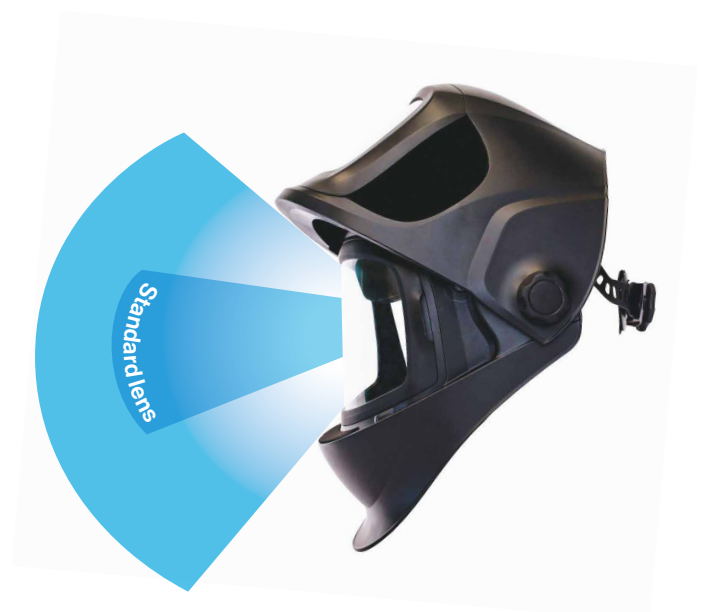

Grinding mode

Now no time lost changing between welding, grinding, and general workshop tasks. Just one easy flip-up action. No need to remove the helmet between jobs.

TM1000

True colour lens, all day comfort



Highest clarity of vision when welding

World's best optical rating 1/1/1/1

- 1 Optical class: No distortion.
- 1 Light diff vision: No double vision.
- 1 Homogeneity: No shade variation.
- 1 Angle dependence: Shade remains consistent when looking at any angle.

2 year lens warranty

Solar powered

with battery backup.
Automatic on-off so ready to weld at any time.



True colour lens

Bringing realistic colour to the welder's world. No more green environments with weak colour contrasts.

107x75mm

auto-darkening view
+ side windows

Easy lens controls

Weld shade adjustment 9-13.
Cutting shade adjustment 5-8.
Sensitivity adjustment 1-10.
Delay adjustment 1-10.

3 adjustable cram straps

To distribute weight and balance better.

Automatic self-adjust sweatband

To fit the head shape perfectly.



Swivelling padded headband

Self-adjust to any head shape with a smooth ratchet, to allow just the right tension for all day comfort wear.

Adjustable distance

between the face and helmet.
Easy to wear it the way you want it, with greater vision



TM1000 FreFlow PAPR

Cooler, cleaner, better productivity!

Combining the TM1000's great benefits with the powered air-purifying respirator for the ultimate productivity, safety and comfort.

Superior lens

Best optical lens 1/1/1/1
Best true colour and clear vision

Great field of vision

With side windows and a flip-up front for a large anti-fog grinding lens

User friendly indicator display

Filter status, airflow rate, battery capacity.

Intelligent air supply

Self-adjust air-flow rate according to the clogging of the filter or battery level.

Li-ion 1 hour

quick charge battery

to give up to 9 hours uninterrupted air-flow.

Adjustable airflow

170 lpm or 210 lpm airflow rates to provide the user better comfort, and cooling in hot or heavy workload conditions.

Designed air outlet

To distribute the airflow to the breathing zone, and around the face to keep the user cooler and keeps air away from eyes.

Flame resistant face seal

to give the welder P3 protection for every shaped face.

Breathing hose

connected to headgear to give the helmet balance. Keeps the hose secure and out of the way.



Comes with a large trade backpack

to store and carry helmet and respirator unit. Extra storage department for spare lens and filters.

TM1000 Specifications, Parts & Accessories



TM1000 Specifications

Optical Class	1/1/1 highest optical class with high definition lens technology (EN379)
Viewing Area	107 x 75 mm
Lens Shade	Variable Shade 5 - 8 / 9 - 13
Light Shade	3
Shade Control	Internal, Digital Display Control
Sensors	4
On/Off	Auto-on/off
Power Supply	Solar cell, + Battery replaceable, 2 x CR2450 lithium battery
Switch Time	1/25,000 s. from Light to Dark
Sensitivity Control	Low - High, Digital Display Control
Delay Time (Dark to Light)	0.1 - 1.0 s, Digital Display Control
Low TIG Rated	Down to 2 amps
Grind Mode	Yes
Grind Lens	200x120mm
Side Windows	Shade 5
Helmet Weight	Standard Helmet 760g, Respiratory version 940g
Magnification Lens	Lens holder, to fit standard 108x51 magnification lenses
Operating Temperature	-5 °C to +55 °C
Storing Temperature	-10 °C to +55 °C
Application Range	Stick Welding (DC&AC). TIG (DC,DC Pulse);TIG AC(Pulse), Excellent low amperage TIG response. MIG/MAG; MIG/ MAG Pulse;Plasma Cutting/ Welding. Grinding. Oxyacetylene Welding/Cutting.
Warranty	Auto Darkening Lens: 2 years
Standards	Helmet: AS/NZS1337.1:2010 High impact rated Lens: AS/NZS1338, EN379
FreFlow Connection	Bayonet connection (Can use Quick Connection if small hose is added to the helmet.)

Spare Parts

Item	Qty	Code
1 Front lens holder	1	WSHWR95007
2 Outside cover lens	1	WSHWR95003
3 Auto darkening filter (ADF950S)	1	WSHWR95012
4 950S Inside cover lens	1	WSHWR95004
5 Grind lens holder	1	WSHWR95008
6 Grind lens (anti-fog)	1	WSHWR95005
7 Helmet shell (non-air)	1	WSHWR95017
7 Helmet shell with airflow	1	WSHWR95018
8 Side lens cover	1	WSHWR95013
9 Face seal	1	WSHWR95016
10 Headgear (non-air)	1	WSHWR95014
10 Headgear for air	1	WSHWR95015
11 12 Sweatbands	1	WSHWR95006
13 Hose Clip (headgear)	1	WSHWR95019
14 Hinge Spring pr	1	WSHWR95011

Optional

Item	Qty	Code
15 Front Leather Throat Protection	1	WSHWR95040
16 TM1000 Back Hood Cover Protection	1	WSHWR95041

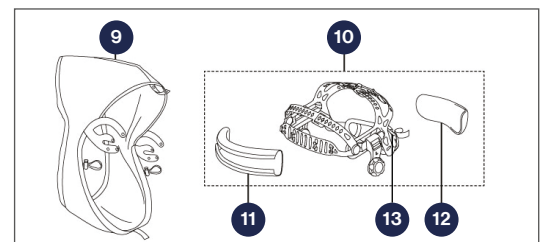
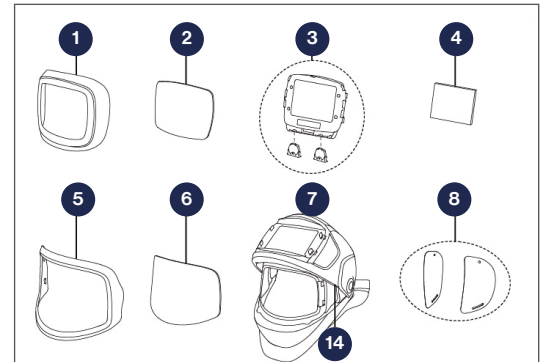

15 Front Leather Throat Protection

- Added leather throat protection for TECMEN welding helmets.
- Protects your neck and upper chest/shoulders from molten metal, sparks and flames.

16 Back Hood Cover Protection

Extra back of head and neck protection to fit your TECMEN welding helmet and respirator.

- To protect you from molten metal, sparks and flames while you weld.
- Flame resistant material.